

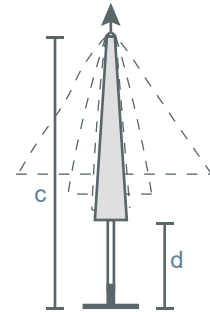

# PARTY CENTERPOST

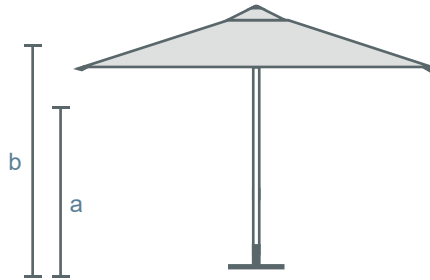
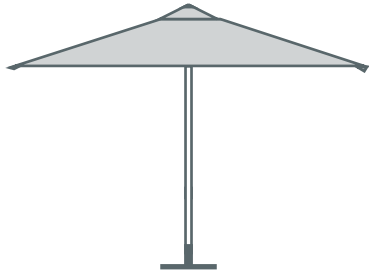

## GENERAL MEASUREMENTS

## DETAILED MEASUREMENTS



MODEL			a		b		c		d	
RPI2525	8' 0" x 8' 0"	250 x 250	7' 7"	230	9' 0"	275	9' 0"	275	3' 1"	95
RPI3030	10' 0" x 10' 0"	300 x 300	7' 7"	230	9' 0"	275	9' 0"	275	2' 2"	65
RPI3535	11' 6" x 11' 6"	350 X 350	8' 0"	245	9' 2"	280	9' 2"	280	1' 2"	35



RPI3525	11' 6" x 8' 0"	350 x 350	7' 7"	230	9' 4"	285	9' 4"	285	2' 4"	70
---------	----------------	-----------	-------	-----	-------	-----	-------	-----	-------	----



RPID25	Ø 8' 0"	Ø 250	7' 1"	215	8' 4"	255	8' 4"	255	4' 3"	130
RPID30	Ø 10' 0"	Ø 300	7' 7"	230	8' 8"	265	8' 8"	265	3' 7"	110
RPID35	Ø 11' 6"	Ø 350	7' 7"	230	9' 0"	275	9' 0"	275	3' 3"	100

- Please refer to the dimensions in centimeters (cm) as the primary measurements. The dimensions in inches (in) are approximate and provided for convenience only.
- All measurements consider the use of an in ground or bolt down base
- Custom sizes available upon request



# PARTY

## SPECIFICATIONS

CATEGORY	Centerpost Umbrella	ALUMINUM FINISH	Ribs and Shaft Powder Coated
SHAFT SIZE	1.97" (50mm) diameter	CANOPY	Yarn Dyed Marine Grade Acrylic 320 gsm
SHAFT ALUMINUM THICKNESS	0.08" (2mm)	UMBRELLA ROTATION	360°
SHAFT MATERIAL	Aluminum	WEIGHT OF STRUCTURE	Approx 40 lbs (18 kg)
NUMBER OF RIBS	8 Ribs	OPENING/CLOSING	Rope and Double Pulley
RIB MEASUREMENTS	1.38" × 0.79" (35mm × 20mm)	TELESCOPIC	No
RIB ALUMINUM THICKNESS	0.08" (2mm)	NUTS, BOLTS, SCREWS	Stainless Steel
RIB MATERIAL	Aluminum	VENT	Soft
RIB JOINTS	Nylon Triangle with Rivets	UMBRELLA COVER	Standard Cover Included

## OPTIONS

Ø

### ▶ RAISED VENT



Raised vent offers a double tier design

## ACCESSORIES

### ▶ GUTTERS

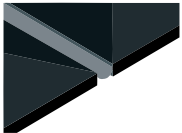

Fabric gutter to connect umbrellas.

Vinyl top for water flow and connected with zipper and velcro.

### ▶ CURTAINS



Fabric curtains to enclose umbrella area.

Can be made with vinyl windows.

Must be used with support rods.

## LIGHTING

### ▶ LUMINARIE



2" pole only



# PARTY

## CANOPY

### ▶ VALANCE

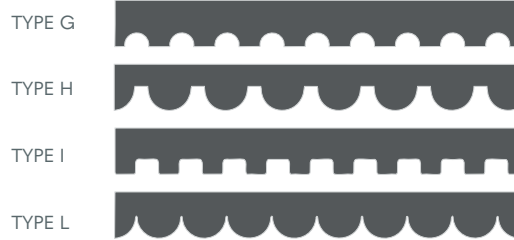
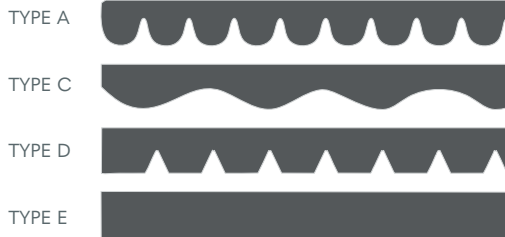

### ▶ ACCENT BORDERS



### ▶ FRINGE



### ▶ CONTRAST BINDING



### ▶ CONTRAST STITCHING

